

MSI

Making Tiles to Suit Your Space & Your Budget

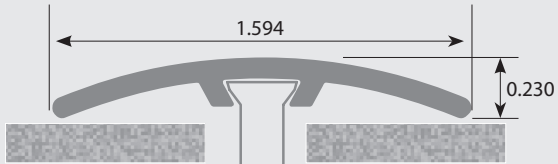

Universal Trim

Transition adjusts to varying levels.
Can be used as T-Moulding or Surface Reducer

Vinyl to Vinyl

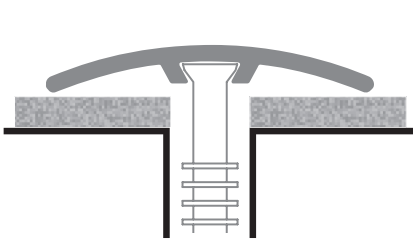

Vinyl to 3/4"

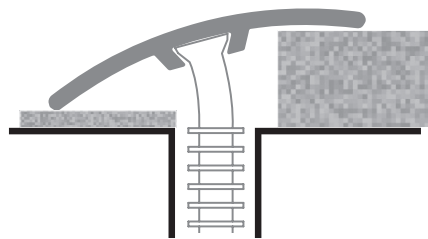

Vinyl to Laminate

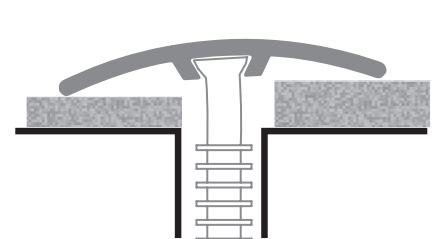

Vinyl to Carpet

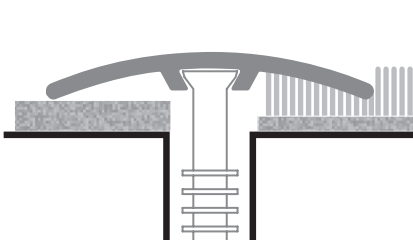

Vinyl to Sliding Door

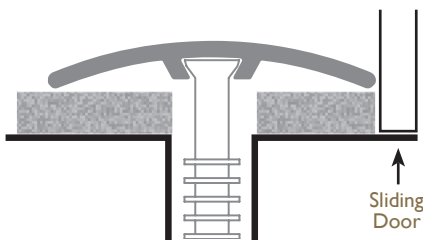

Laminate to 3/4"

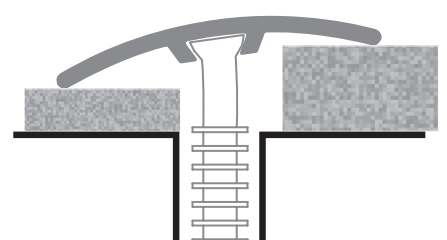

Vinyl to Ceramic Tile

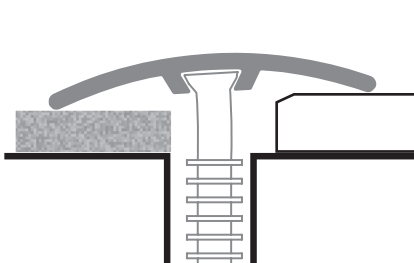

Laminate to Carpet

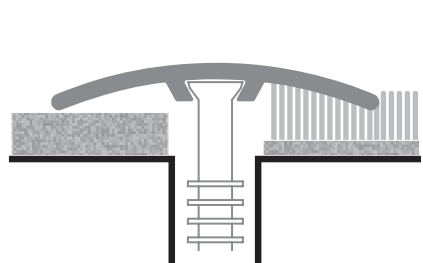

Laminate to Sliding Door

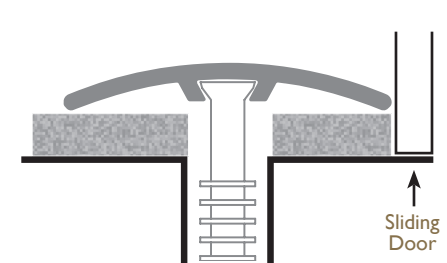

BASIC INSTALLATION INSTRUCTIONS

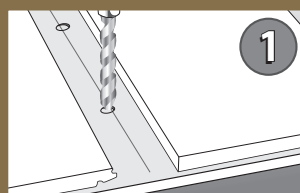

1 Draw a line 3/8" from floor's edge. Drill 1/4" holes along line (approx. 15" apart).



2 Slide plugs into slot on moulding. Align with pre-drilled holes.

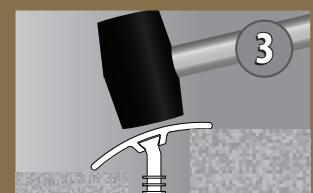

3 Tap down moulding to required level using a rubber mallet.

MADE IN THE USA